

Sanctuary Memory Care at Rye—Rye, NH started 6-2012

Construction of a single story 805 Licensed Alzheimer's care center. Ground up new construction with an approximate 37,000sf footprint including 56 patient rooms, commercial kitchen facilities, non-skilled nurse stations and administrative spaces. The structure is wood framed and the exterior shell is constructed with various exterior envelope and roofing materials, medium to higher end finishes will be applied to interior spaces. This is an extremely tight budget with specific focus on elements of construction and code compliance, specifically HVAC. The project requires a very strong Site Superintendent in order to maintain an aggressive 10 month construction schedule.



Peter Sanborn Place Reading, MA

Peter Sanborn Place is a federally subsidized supportive living community for elderly, disabled and handicapped individuals that is owned and operated by The Peter Sanborn Place, Board of directors. This is a multi-phased project in which Phase I has been completed. Phase I renovations to existing assisted living facility to include, the renovations/upgrades to 26 H/C compliant rooms including kitchen and bathroom renovations, new ceramic tile showers, flooring and carpet, new windows, new fire suppression system throughout the building, electrical renovations in units, addition to community room, renovations/expansion to commercial kitchen and new common area ceilings, flooring and paint. Phase I approx. cost \$2,000,000.00

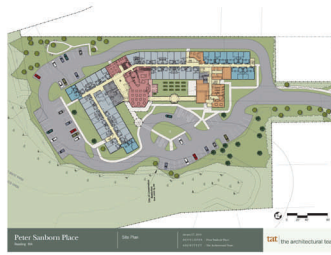

Sullivan Construction, Inc. enjoys a 41 year history in providing services to the senior care industry.

Tammany Park, Dover, NH. – This project is a forty-two (42) unit residential apartment complex for Chad Kageleiry. We have completed over two (2) dozen projects for Chad Kageleiry over the last twelve (12) years, ranging from 500K to 18MM in value.

Briston Manor West, Bedford, NH – Sullivan Construction, Inc built this seventy (70) unit congregate care facility. These units have full kitchens and a commercial kitchen which offers one meal per day to its residents.

Ridgewood Nursing Facility, Bedford, NH – This three (3) story 100 bed nursing facility was constructed to include a full kitchen, dining room, nurse's stations and all services. Two (2) years later we added a three (3) story, fifty (50) bed wing onto this occupied nursing home facility. The facility is a Genesis property.

Morville House, Boston MA – this project was completed successfully involving adding the baseboard heating system in occupied resident rooms in both an existing five (5) story tower and twelve (12) story tower. In addition to these improvements, a new twelve (12) story tower was constructed.